

Put a hollow head screw wrench into the bush which is placed into the aluminium knob.

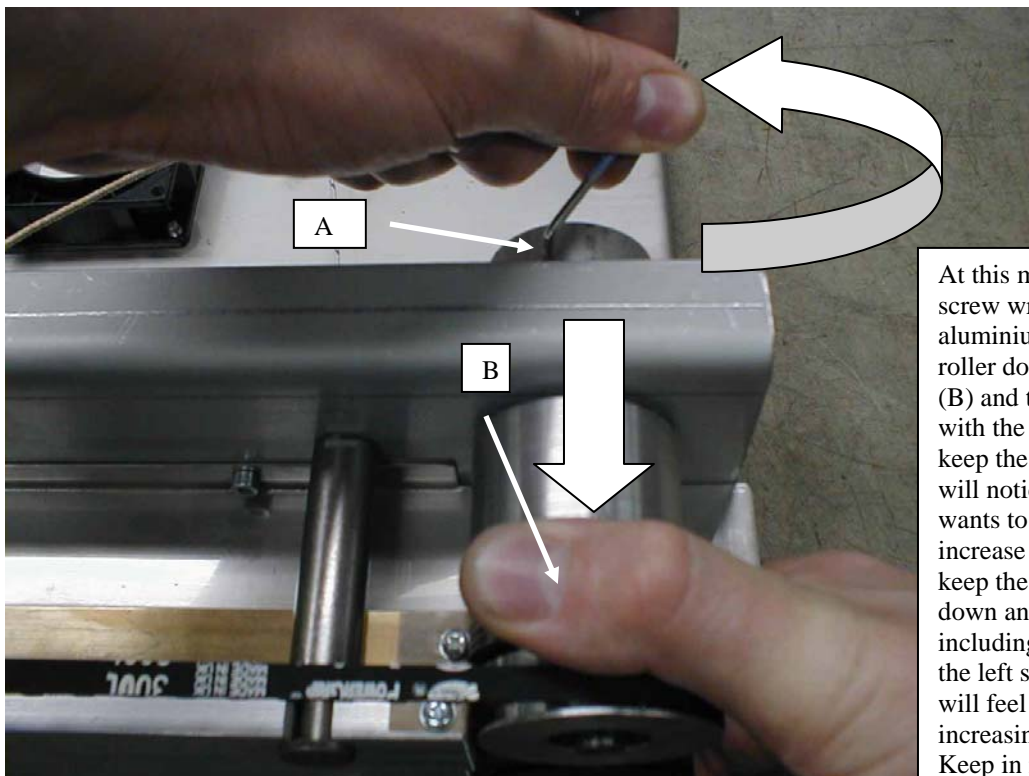

At this moment the hollow head screw wrench (A) is still into the aluminium knob. Put the pressure roller down as mentioned with (B) and then release the screw with the crew wrench (A). If you keep the pressure roller pushed down you will notice that the crew driver wants to flip to the right side. To increase the pressure you should keep the pressure roller pushed down and turn the crew wrench including the aluminium knob to the left side. As you do this you will feel that the tension is increasing. Keep in mind that the final position of the screw should be fixed a little more to the left instead of completely in the middle.

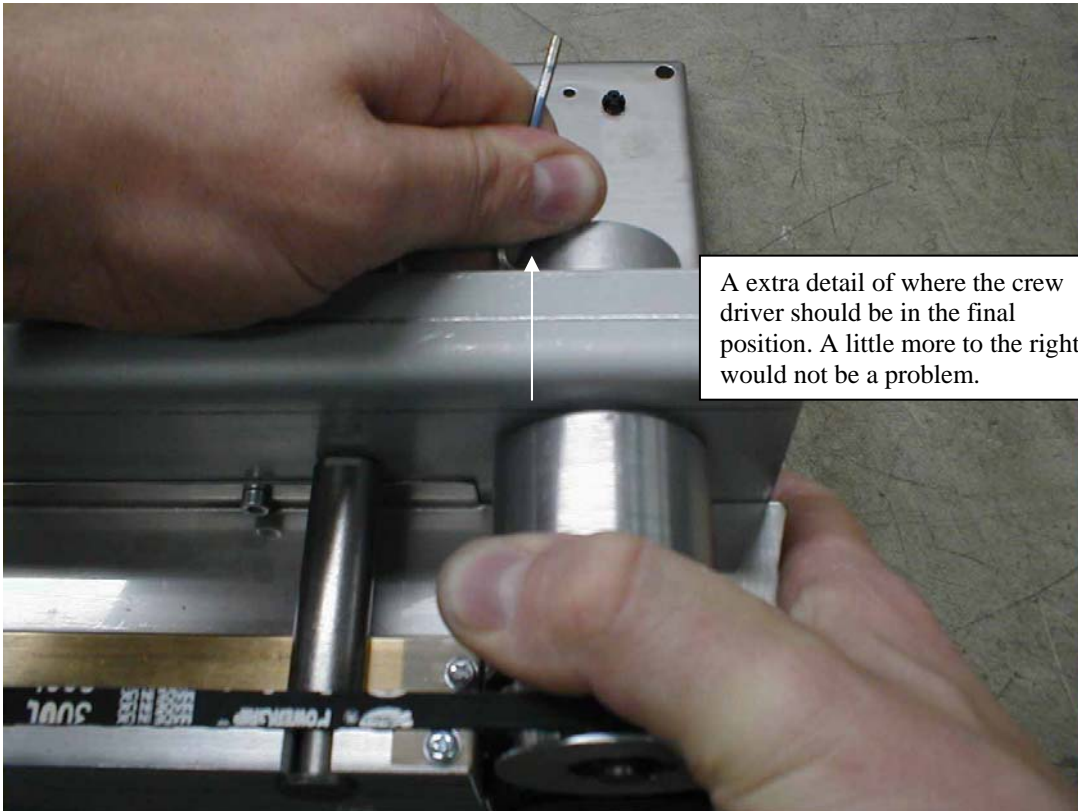

A extra detail of where the crew driver should be in the final position. A little more to the right would not be a problem.

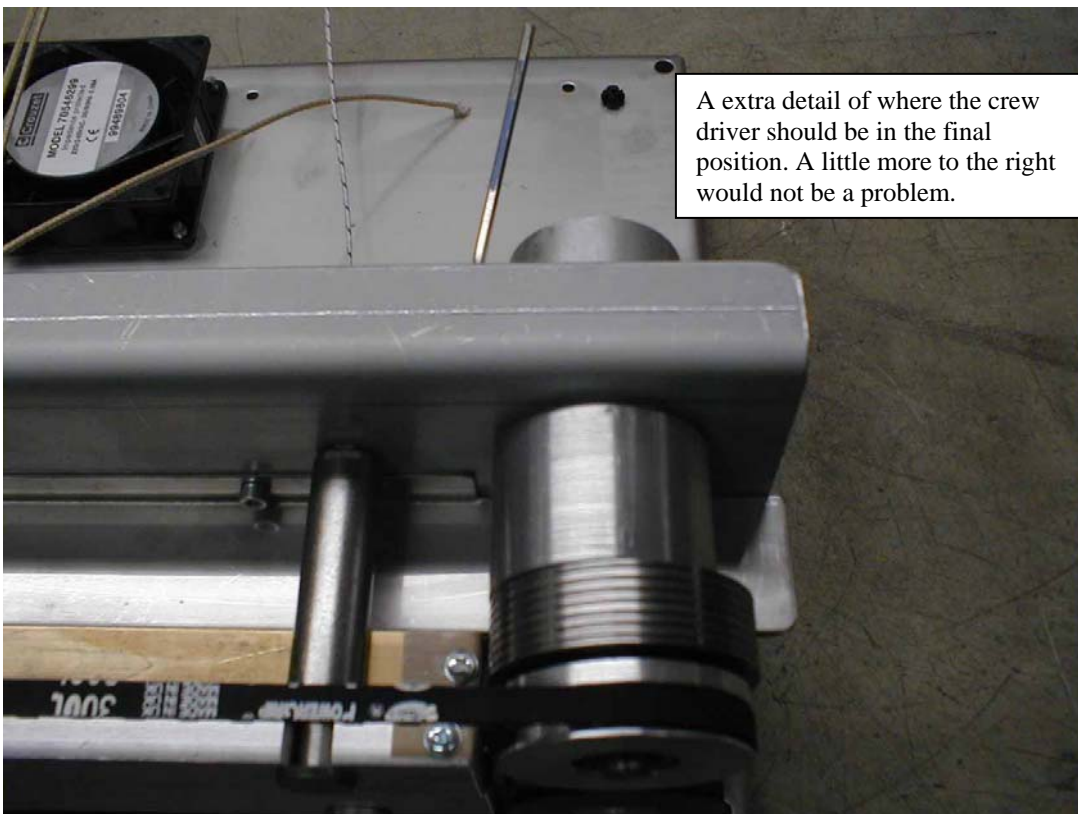

A extra detail of where the crew driver should be in the final position. A little more to the right would not be a problem.

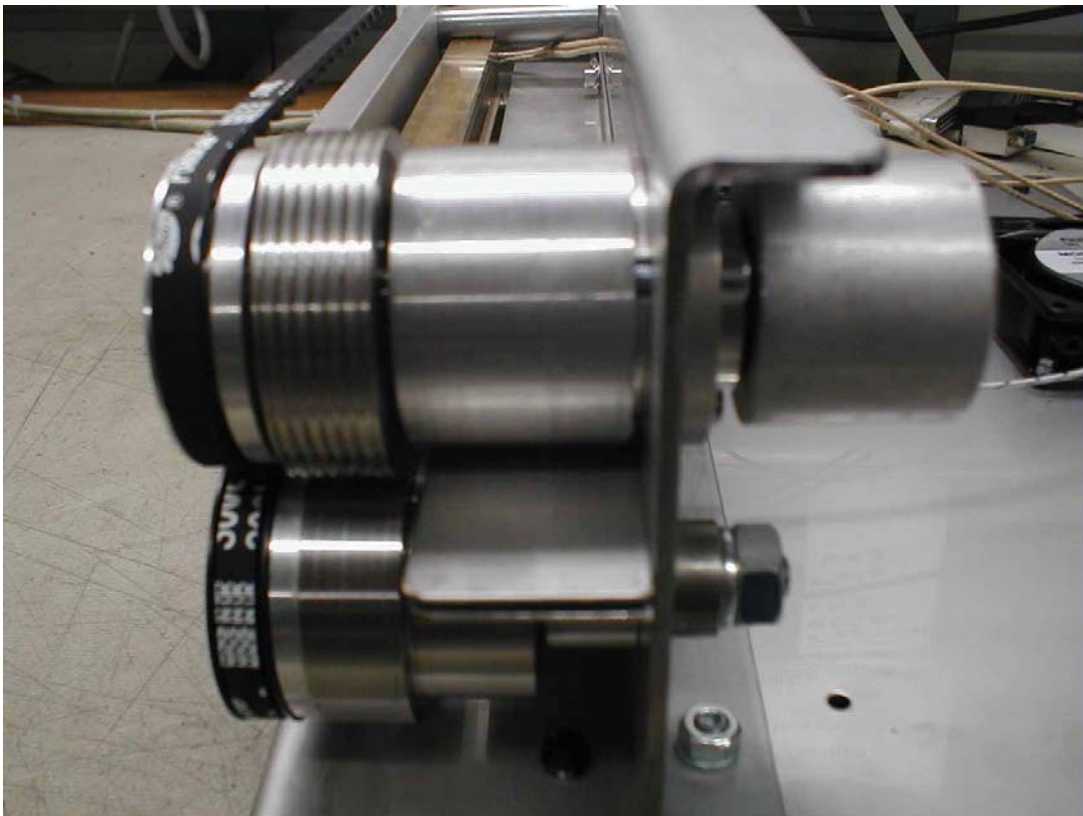
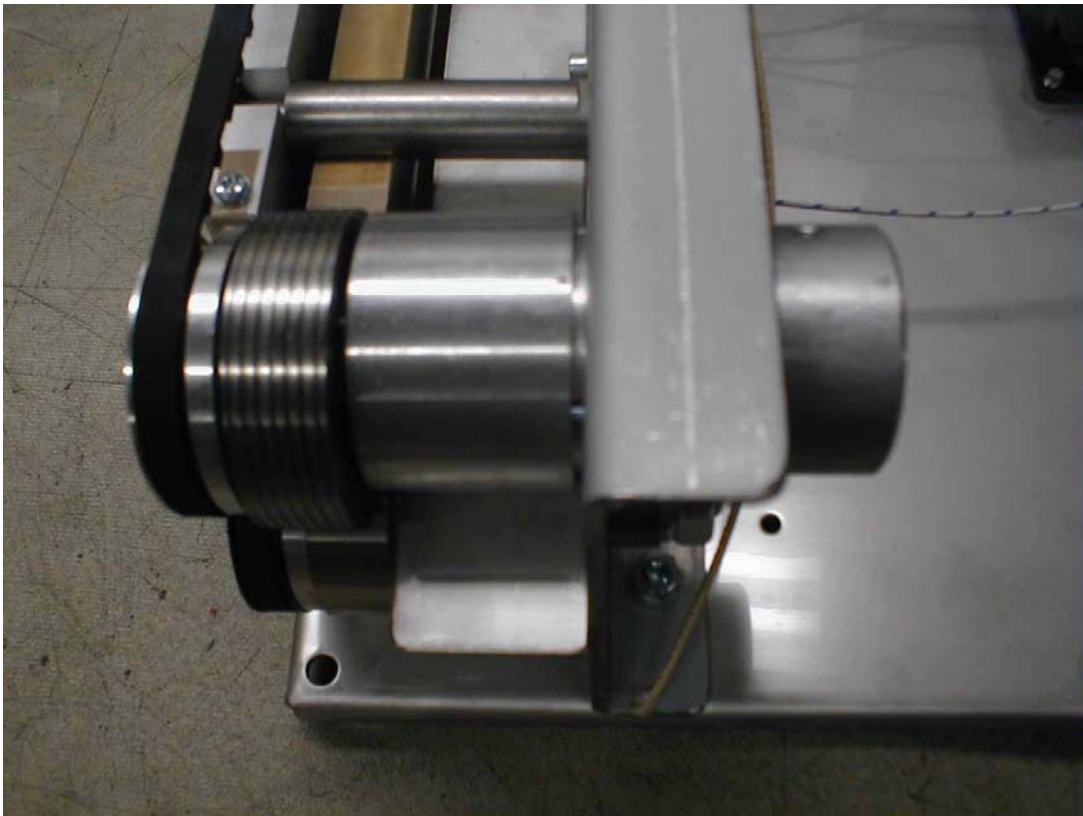

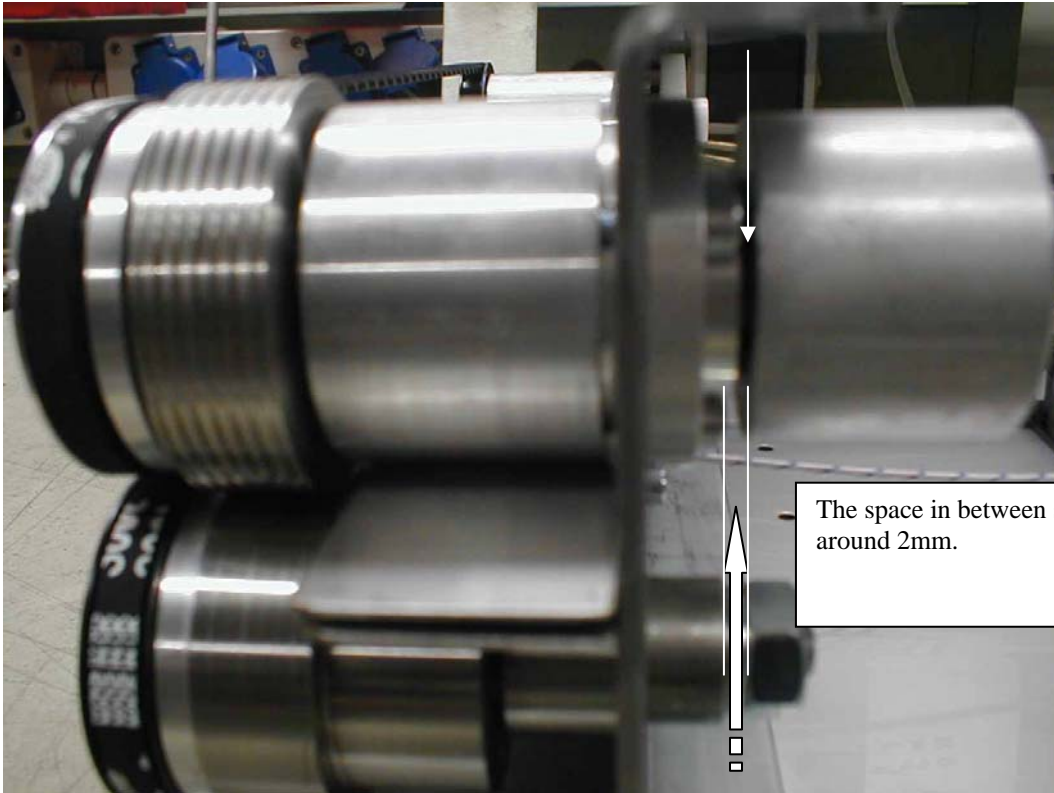

The space in between should be around 2mm.